

277-265

969626

277-249

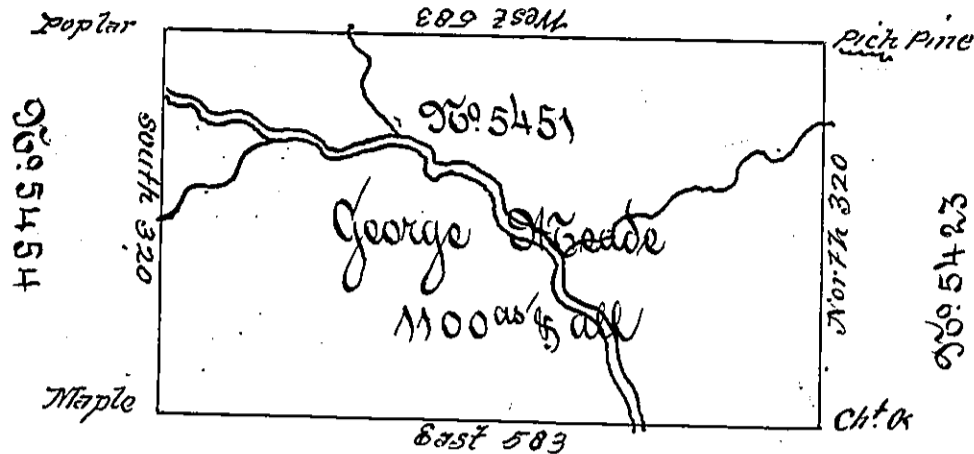

250-229

9695423

9695452

275-160

Situate on the North branch of Sinnemahoning Creek in North⁴ County containing 1100 acres and the usual allowance for roads surveyed May 8th 1794 for George Heade in pursuance of a Warrant 9695451 dated 3^d March 1794

Daniel Brodhead Esq. D.C.

John Casan
D.S.

IN TESTIMONY that the above is a copy of the original remaining on file in the Department of Internal Affairs of Pennsylvania, made conformably to an Act of Assembly approved the 16th day of February, 1833, I have hereunto set my Hand and caused the Seal of said Department to be affixed at Harrisburg, this first day of October 1901.

James W. Latta
Secretary of Internal Affairs.